



INVICTA

Movement Caliber VD53

INFO

- The measurement time indicated by the stopwatch hands move independently of the center hands.
- Chrono 1/10 sec : The stopwatch 1/10 second hand moves for a first minute. After one minute, it indicates the measurement time when it is stopped.

Movement Caliber : VD53

Presentation

Display Elements

Minutes Hand

Hour Hand

Stopwatch
Minutes Hand
(Move in second
increments)

Second Hand

Stopwatch
Minutes Hand
(Move in second
increments)

24-Hour Hand
(Indicates the time on
a 24-Hour basis)

Date Window

Control Buttons

Push Button A

In stopwatch function:
Start / Stop



Crown Positions
1: Date setting
2: Time setting

Push Button B

In stopwatch function:
Split / Split release / Reset

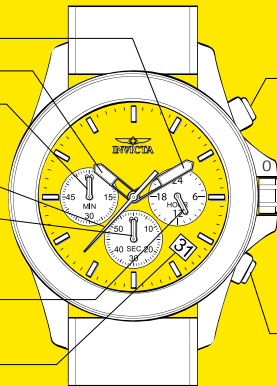

Movement Caliber : VD53

Setting

Adjusting the Stopwatch Hand Position

Before setting the time, check if all the chronograph hands - second, minute - are at the "0" (12 o'clock) position.

- If the stopwatch is in use, press the buttons in the following order to reset it, and then, check if the hands return to "0" position.
(For details, see "HOW TO USE THE STOPWATCH")
- If the chronograph is counting : **A > B**
- If the stopwatch is stopped : **B**
- If the split time is displayed: **B > A > B**

If either of the stopwatch hands are not in the "0" position , reset them following the procedure below



Press button A or B to reset all stopwatch hands to "0" position.

- The stopwatch minute hand moves correspondingly with the stopwatch second hand.
- The hands move quickly if the respective buttons are kept pressed.

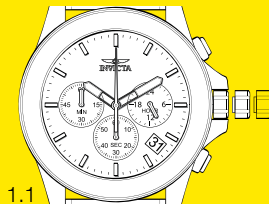

Pull the crown out to position 2.



Push the crown back to the normal position.

Movement Caliber : VD53

Setting

Time Setting

- Before setting the time, check that the chronograph measurement is stopped.
- Do not set the date between 9:00 P.M. and 1:00 A.M, otherwise the day may not change properly. If it is necessary to set the date during the time period, firstly change the time to any time outside it, set the date and then reset the correct time.

2.1 Pull out the crown to the position 1

2.2 Turn the crown clockwise until the preview day's date appears.

2.3 Pull out the crown to the position 2 when the second hand is at the 12 o'clock position. It will stop on the spot. Set the hands to the desired time of the day (make sure AM/PM is set correctly) by turning the crown.

- When the crown is at the second click position, do not press any button. Otherwise the chronograph hands will move.

2.4 Push the crown back in the normal position in accordance with a time signal.



2.1

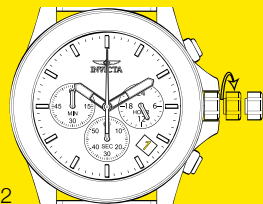

2.2

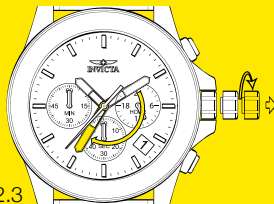

2.3

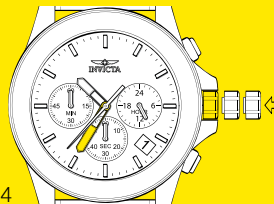

2.4

Movement Caliber : VD53

Functions

How to Use the Stopwatch

- The measurement time is indicated by the stopwatch hands that move independently of the center hands (and 24-hour hand where applicable).
- The stopwatch can measure up to 60 minutes.

Standard Measurement

E.g. 100m race (Press the buttons in the following order A > A > B)



3.1

Start

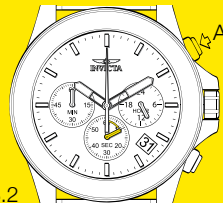

3.2

Stop (Finish) 10 Seconds

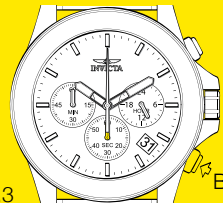

3.3

Reset (Reset to "0'00")

Movement Caliber : VD53

Functions

Accumulated Elapsed Time Measurement

E.g. basketball game

(Press the buttons in the following order A > A / A ... > A > B)

Restart and stop of the stopwatch can be repeated as many times as necessary by pressing button A.

4.1 Start > Stop (Start of game) (Time out)

4.2 Restart (Restart of game), 5 Seconds 10 Seconds

4.3 Stop (Game Over), 20 Seconds 00 Seconds

4.4 Reset

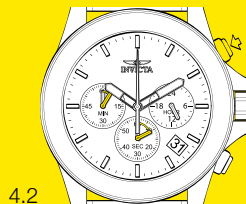

Movement Caliber : VD53

Functions

Split Time Measurement

E.g. 5,000m race

(Press the buttons in the following order A > B / B ... > A > B)

Measurement and release of the split time can be repeated as many times as necessary by pressing button B.

5.1 Start

5.2 Split / Split release, 5 Minutes 50 Seconds

5.3 Stop, 15 Minutes 10 Seconds

5.4 Reset

